

# JLWMI405

## 1400 spin washing machine

### Instruction manual

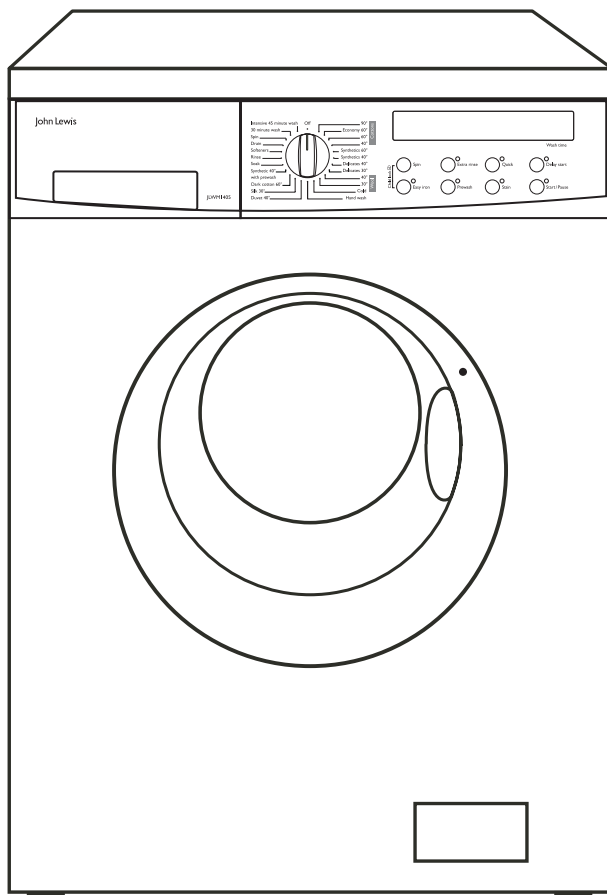

**John Lewis**



# Important Safety Information

It is most important that this instruction book should be retained with the appliance for future reference. Should the appliance be sold or transferred to another owner, or should you move house and leave the appliance, always ensure that the book is supplied with the appliance in order that the new owner can get to know the functioning of the appliance and the relevant warnings.

These warnings have been provided in the interest of safety. You **MUST** read them carefully before use or installation by a qualified person.

If you are unsure of the meanings of these warnings contact the John Lewis branch from which you purchased the appliance.

## Installation

- This appliance is heavy. Care should be taken when moving it.
  - It is dangerous to alter the specifications or attempt to modify this product in any way.
  - All packing and transit bolts must be removed before use. Serious damage can occur to the product and to property if this is not adhered to. See relevant section in instructions.
  - Care must be taken to ensure that the appliance does not stand on the electrical supply cable.
  - If the machine is situated on a carpeted floor, please adjust the feet in order to allow air to circulate freely.
- Only wash fabrics which are designed to be machine washed. If in doubt, consult the care label on the clothes.
  - Before washing, ensure that all pockets are empty and buttons and zips are fastened. Avoid washing frayed or torn articles and treat stains such as paint, ink, rust, and grass before washing. Underwired bras must **NOT** be machine washed.
  - Any objects such as coins, safety pins, nails, screws, stones or any other hard, sharp material can cause extensive damage and must not be placed into the machine.
  - Garments which have been in contact with volatile petroleum products should not be machine washed. If volatile cleaning fluids are used, care should be taken to ensure that the fluid is removed from the garment before placing in the machine.
  - Wash small items such as socks, laces, washable belts etc in a washing bag or pillow case as it is possible for such items to slip down between the tub and the inner drum.
  - Only use the advised quantities of fabric softener. Damage to the fabric can ensue if you over-fill. Refer to the manufacturer's recommendations of quantities.
  - As some duvets and eiderdowns should be washed in large commercial machines because of their bulk, please check with the manufacturer of the item before washing in a domestic machine.

## Child Safety

- This appliance is designed to be operated by adults. Children should not be allowed to tamper with the controls or play with the product.
- Pets and children have been known to climb into washing machines. Please check your drum before use.
- The glass door becomes very hot during the washing cycle. Keep children away from the vicinity of the appliance whilst it is in operation.
- Keep all packaging well away from children.
- Keep all detergents in a safe place out of children's reach.
- When the appliance is to be scrapped, cut off the electrical supply cable and destroy the plug with the remaining cable. Disable the door catch in order to prevent children from becoming trapped inside while playing

## Use

- Always unplug the appliance and turn off the water supply after use.
- Do not overload the appliance. See relevant section in the instruction book.

## Maintenance and Cleaning

- Leave the porthole door slightly ajar between washes to preserve the door seal.
- For information on maintenance and cleaning your washing machine see page 23 of this Instruction manual.

## Service

- This product should only be repaired or serviced by an authorised Service Engineer and only genuine approved spare parts should be used.

## Ecological hints

To save water and energy and help protect the environment, we recommend that you follow these hints:

- Normally soiled laundry may be washed without prewashing in order to save detergent, water and time (the environment is protected too!).
- The machine works more economically if it is fully loaded.
- With adequate pre-treatment, stains and limited soiling can be removed; the laundry can then be washed at a lower temperature.
- Measure out detergent according to the water hardness, the degree of soiling and the quantity of laundry being washed.

## Environment Information

- Materials marked with the symbol  are recyclable.
- Check with your local Council or Environmental Health Office to see if there are facilities in your area for re-cycling this appliance.
- When the appliance is to be scrapped, cut off the power supply cable and make the door lock device unusable to prevent young children from being trapped inside.
- Help to keep your country tidy - use authorised disposal sites for your old appliance.

The symbol  on the product or on its packaging indicates that this product may not be treated as household waste. Instead it shall be handed over to the applicable collection point for the recycling of electrical and electronic equipment. By ensuring this product is disposed of correctly, you will help prevent potential negative consequences for the environment and human health, which could otherwise be caused by inappropriate waste handling of this product. For more detailed information about recycling of this product, please contact your local city office, your household waste disposal service or the shop where you purchased the product.

## Important

Your machine is fitted with a balance control device, which ensures the machine is stable during the spin. If the wash load appears not to have been spun sufficiently at the end of the wash cycle, because it is not evenly distributed in the drum, the balance control device may have operated. It will therefore be necessary to redistribute the wash load manually and select a spin programme. For more detailed information see the section headed “Something Not Working”.

# Contents

## For the User

<b>Important Safety Information</b>	<b>2</b>
<b>Description of the Appliance</b>	<b>5</b>
Door lock indicator	5
Detergent dispenser drawer	5
Child safety feature	5
<b>The Control Panel</b>	<b>11-15</b>
<b>Programme information</b>	<b>15</b>
<b>Special features</b>	<b>16</b>
<b>Using your washing machine</b>	<b>17-18</b>
Load the laundry	17
Measure out the detergent	17
Measure out the fabric softener	17
Select the desired programme	17
Select the spin speed or the “No spin” option	17
Select the desired options	17
Select the “Delay start”	18
Start the programme	18
How to change an option or a programme during its cycle	18
How to interrupt a programme	18
How to open the door during the cycle of a programme	18
End of programme	18
<b>Hints and tips on Washing</b>	<b>19</b>
<b>Wash Care Symbols</b>	<b>20</b>
<b>Washing Programmes</b>	<b>21-22</b>
<b>Maintenance and Cleaning</b>	<b>23-24</b>
Descaling	23
After each wash	23
Maintenance Wash	23
External cleaning	23
Cleaning the dispenser drawer	23
Cleaning the drawer recess	23
Cleaning the pump	23-24
Cleaning the water inlet filter	24
The dangers of freezing	24
Emergency emptying out	24
<b>Something Not Working</b>	<b>25-26</b>
<b>Repairs - After Sales Service</b>	<b>27</b>

## For the Installer

<b>Installation</b>	<b>6</b>
<b>Technical Specifications</b>	<b>6</b>
Unpacking	7
Positioning	7
Water inlet	8
Water drainage	8-9
Levelling	9
Special conditions	9
In the interest of the environment	9
<b>Electrical connection</b>	<b>10</b>

## Guide to use the Instruction Manual

The following symbols will be found in the text to guide you throughout the instructions:



**Safety instructions**



**Hints and tips**



**Environmental information**



This appliance complies with the following E.E.C. Directives:  
- 73/23 EEC of 19.2.73 (Low Voltage Directive) and subsequent modifications;  
- 89/336 EEC of 3.5.89 (Electromagnetic Compatibility Directive) and subsequent modifications.

# Description of the Appliance

- 1 Detergent dispenser drawer
- 2 Control panel
- 3 Door opening handle
- 4 Filter
- 5 Adjustable feet
- 6 Door lock indicator

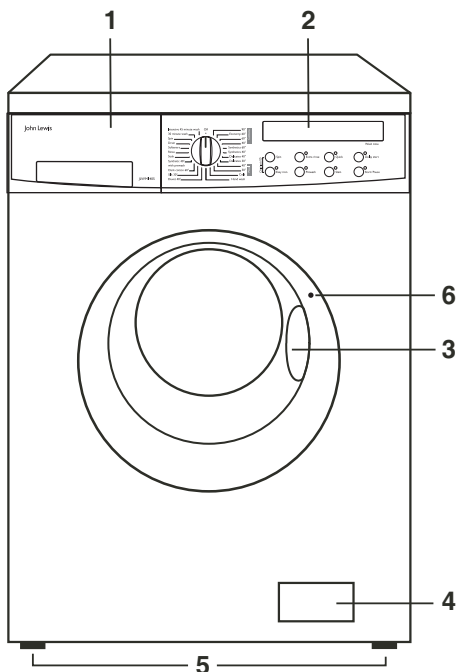



## Door lock Indicator

It stays on during the whole programme indicating that the door is locked.

When the light goes out, the door can be opened.

## Detergent dispenser drawer

-  Prewash
-  Main wash
-  Fabric softener
-  Bleaching agent

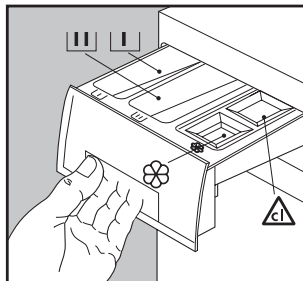

## Child safety feature



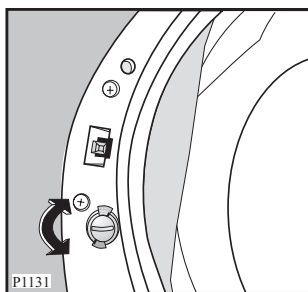

This machine incorporates a special child safety feature to prevent small children from being trapped inside the machine.

To activate this device, rotate the button (without pressing it) inside the door clockwise until the groove is horizontal. If necessary use a coin.

To disable this device and restore the possibility of closing the door, rotate the button anti-clockwise until the groove is vertical.



# Installation

-  It is dangerous to alter the specifications or attempt to modify this product in any way.
-  Care must be taken to ensure that the appliance does not stand on the electrical supply cable.
-  Any electrical work required to install this appliance should be carried out by a qualified electrician or competent person.
-  Any plumbing work required to install this appliance should be carried out by a qualified plumber or competent person.

## Technical specifications

DIMENSIONS	Height Width Depth	85 cm 60 cm 60 cm
MAXIMUM LOAD	Cotton Synthetics Delicates Woollens Hand wash Silk	7.0 kg 3.0 kg 3.0 kg 2.0 kg 2.0 kg 1.0 kg
SPIN SPEED		1400 rpm max.
POWER SUPPLY VOLTAGE/ FREQUENCY TOTAL POWER ABSORBED		230-240 V/50 Hz 2200W
MINIMUM FUSE PROTECTION		10 A
WATER PRESSURE	Minimum Maximum	0.05 MPa 0.8 MPa

# Unpacking

**Warning !** Slide out the polythene bag containing the polystyrene block before using the appliance. Pull off adhesive strips from inside machine on top of drum. Keep all packaging away from children



All transit bolts and packing must be removed before using the appliance.

You are advised to keep all transit devices so that they can be refitted if the machine ever has to be transported again.

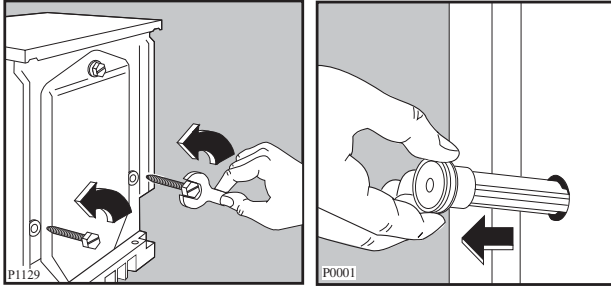

- Using a spanner, unscrew and remove the two rear bottom screws. Slide out the two plastic pins. Lay the machine on its back, taking care not to squash the hoses. This can be avoided by placing one of the corner packing pieces between the machine and the floor

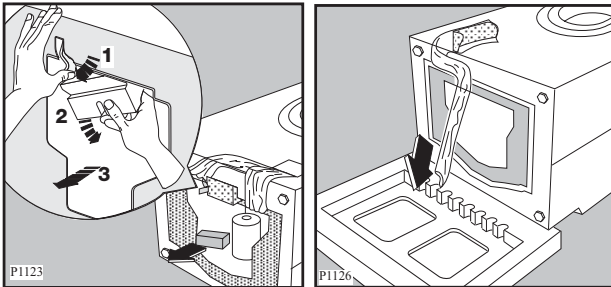

- Remove the polystyrene block(s) from the bottom of the machine and release the two plastic bags.
- Very carefully slide out the left polythene bag, removing it towards the right and then downwards.

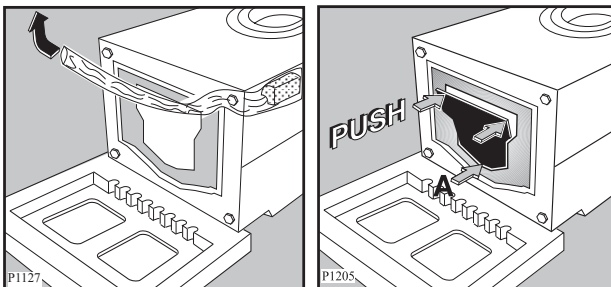

- Very carefully slide out the right polythene bag, removing it towards the left and then upwards. Remove the bottom cover found inside the drum of your appliance, lay it's hook as the arrow 'A' indicates and push the top of the cover to seal it closed.

- Set the machine upright and remove the remaining rear screw. Slide out the relevant pin.
- Plug all the holes with the plugs which you will find in the envelope containing the instruction manual.

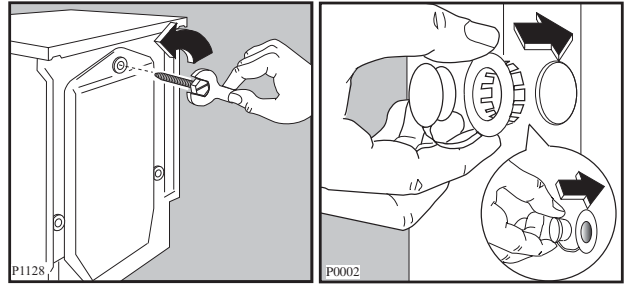

## Important !

You are advised to keep all the packaging for re-use in case the machine is to be transported again. In case of moving out the same precautions as per paragraph "The dangers of freezing" must be taken i.e. the residual water in the hoses must be pumped out.

Keep all packaging away from children

## Positioning

Install the machine on a flat hard floor.

Make sure that air circulation around the machine is not impeded by carpets, rugs etc. Check that the machine does not touch the wall or other kitchen units.

Never place cardboard, wood or similar materials under the machine to compensate for any unevenness in the floor.

Your new washing machine has been designed to be permanently plumbed in to your home's water supply and drainage system. However, if this is not possible, it may be connected to suitable existing tap with the drain hose discharging into a sink.

The appliance has one inlet hose, with female 3/4" BSP thread connector. If this connection is not compatible with the plumbing of the existing installation, a variety of connectors are available from good hardware stores and plumber merchants to suit most domestic plumbing. Any alteration to your existing plumbing must be carried out by a competent person, or qualified plumber.

## Installation on a Suspended Floor

Suspended wooden floors are particularly susceptible to vibration. To help prevent vibration we recommend you place a waterproof wood panel, at least 15 mm thick under the appliance, secured to at least 2 floor beams with screws. If possible install the appliance in one of the corners of the room, where the floor is more stable.

## Water inlet

Connect the hose to a tap with a 3/4" thread. Always use the hose supplied with the appliance to connect to the water supply. Do not use previously used hoses for water connection.

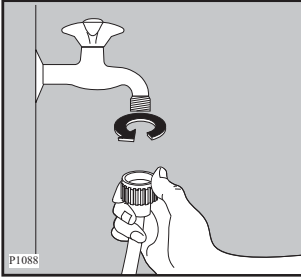

Installation should comply with local water authority and building regulations' requirements.

The appliance must be connected to a cold water supply.

A minimum water pressure of 0.05 MPa is required for safe operation of the appliance.

If you cannot make the cold water connection direct from the rising mains, you may be able to operate the appliance from your cold water storage system.

There should be a minimum distance of 5.02m (16.5 ft) between the appliance's inlet and the bottom of the water storage tank.

Set the hose correctly by loosening the ring nut. After positioning the inlet hose, be sure to tighten the ring nut again to prevent leaks.

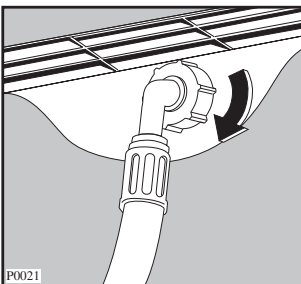

## Water drainage

This appliance is designed to be permanently plumbed into your home's drainage system using one of the following methods.

### I. Into a drainage standpipe.

Firstly form a hook in the end of the drain hose using the "U" piece" supplied.

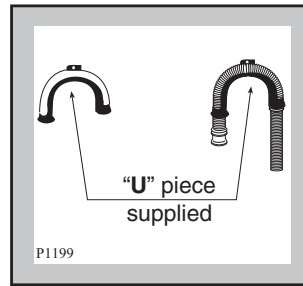

Place the drain hose into your standpipe, which should have an internal diameter of approximately 38mm thus ensuring there is an air break between the drain hose and standpipe.

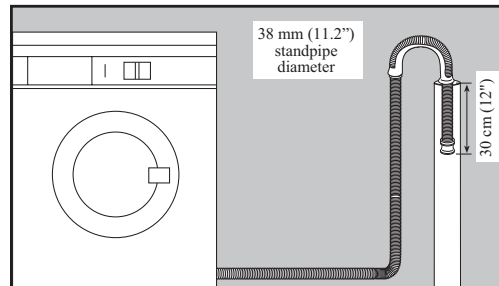

When discharging into a standpipe ensure that the top of the standpipe is no more than 90cm (35.4") and no less than 60cm (23.6") above floor level.

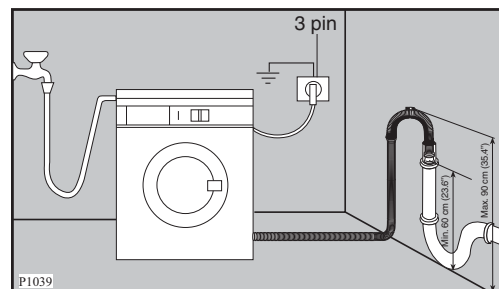

The drain hose may be extended to a maximum of 4 metres. An additional drain hose and joining piece is available from your local Service Force Centre. The joining piece must have an internal diameter of 18mm.

If your drain hose looks like this (see below) you do not require the "U" piece". Just push the hose firmly into the standpipe.

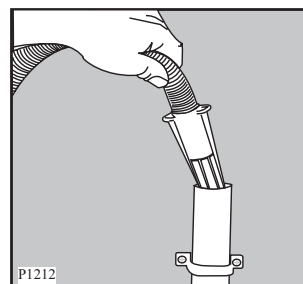



## 2. Onto a sink outlet spigot.

If the outlet spigot has not been used before, remove any blanking plug that may be in place.

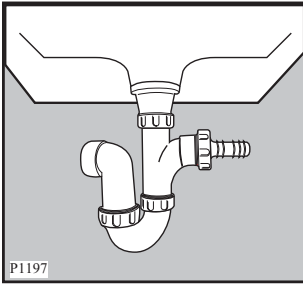

Push the drain hose onto the spigot and secure with a clip if required, ensure a loop is formed in the drain hose (see diagram) to prevent waste from the sink entering the washing machine.

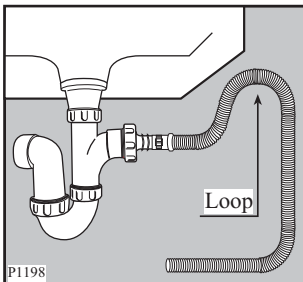

### Important

- Before connecting the machine to new pipework or to pipework that has not been used for some time, run off a reasonable amount of water to flush out any debris that may have collected in the pipes.
- For a correct functioning of the machine the drain hose must be hooked on the proper support piece situated on the top of the back side of the appliance.

### Levelling

Level the washing machine by raising or lowering the feet. The feet may be tight to adjust as they incorporate a self locking nut, but the machine **MUST** be level and stable (check diagonally).

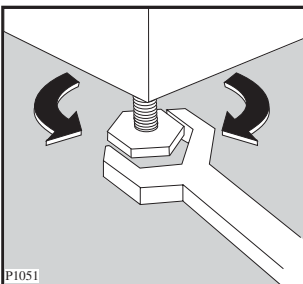

Any necessary adjustment can be made with a spanner. Accurate levelling prevents vibration, noise and displacement of the machine during operation.

Some vibration is inevitable, especially if mounted on a wooden floor.

Sprung wooden floors are particularly susceptible to vibration. For advice, consult a builder. If possible, always place the machine on a solid floor.

### Special conditions

If the floor is carpeted or covered with crumbly or soft material, insert a rigid support base under the feet to prevent noise, vibration or displacement. The base should protrude a few centimetres beyond the edges of the machine.



#### Warning

The machine should **NOT** be placed on deep pile carpeting.

#### Note

Please ensure that when the appliance is installed it is easily accessible for the engineer in the event of a breakdown.

### In the interest of the environment

Washing machines and dishwashers should be connected to the FOUL drainage system, the water will then be taken to a sewage works for treatment before being discharged safely into a river.

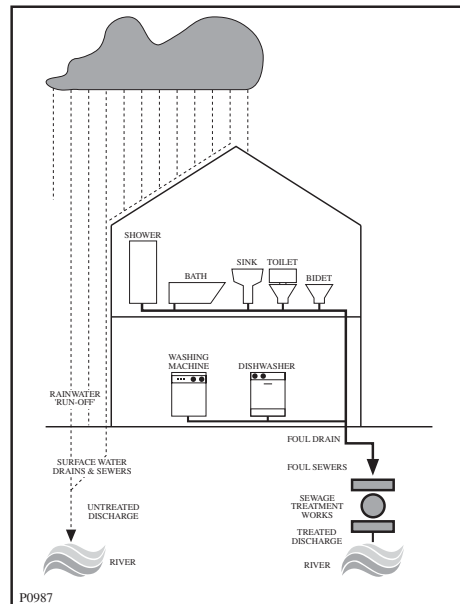

It is essential that these appliances are not connected to the surface water drainage system as this water is discharged directly into a river or stream and may cause pollution.

If you require any further advice please contact your local water authority.

# Electrical Connection

Any electrical work required to install this appliance should be carried out by a qualified electrician or competent person.

---

**WARNING: THIS APPLIANCE MUST BE EARTHED.**



Should the appliance power supply cable need to be replaced, this must be carried out by a Service Force agent (see page 26). The manufacturer declines any liability should this safety measure not be observed.

Before switching on, make sure the electricity supply voltage is the same as that indicated on the appliance's rating plate. The rating plate is located at the top of the rim of the open door.

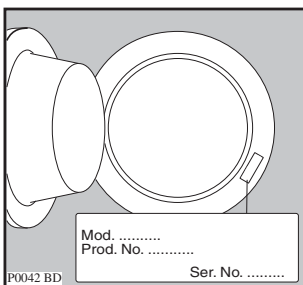

The appliance is supplied with a 13amp plug fitted. In the event of having to change the fuse in the plug supplied, a 13amp ASTA approved (BS1363/A) fuse must be used.

Should the plug need to be replaced for any reason, proceed as described below.

The wires in the mains lead are coloured in accordance with the following code:

- Green and Yellow - Earth
- Blue - Neutral
- Brown - Live

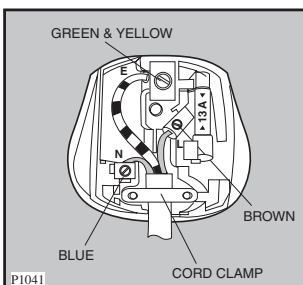

The wire coloured green and yellow must be connected to the terminal marked with the letter «E» or by the earth symbol  $\perp$  or coloured green and yellow.

The wire coloured blue must be connected to the terminal marked «N» or coloured black.

The wire coloured brown must be connected to the terminal marked «L» or coloured red.

Upon completion there must be no cut, or stray strands of wire present and the cord clamp must be secure over the outer sheath.

---

**WARNING:**



A cut off plug inserted into a 13 amp socket is a serious safety (shock) hazard. Ensure that the cut off plug is disposed of safely.



The plug must still be accessible after the appliance has been installed



The appliance should not be connected to the electrical supply by means of an extension cable.

The power supply cable must be easily accessible after installing the appliance.

**Important**

If the mains supply cable is damaged it must be replaced; contact our warranty administrators on 0870 0107887 who will give you details for your local Service Force Centre.

## Permanent connection

In the case of permanent connection it is necessary that you install a double pole switch between the appliance and the electricity supply (mains), with a minimum gap of 3mm between the switch contacts and of a type suitable for the required load in compliance with the current electrical regulations.

The switch must not break the yellow and green earth cable at any point.

# The Control Panel

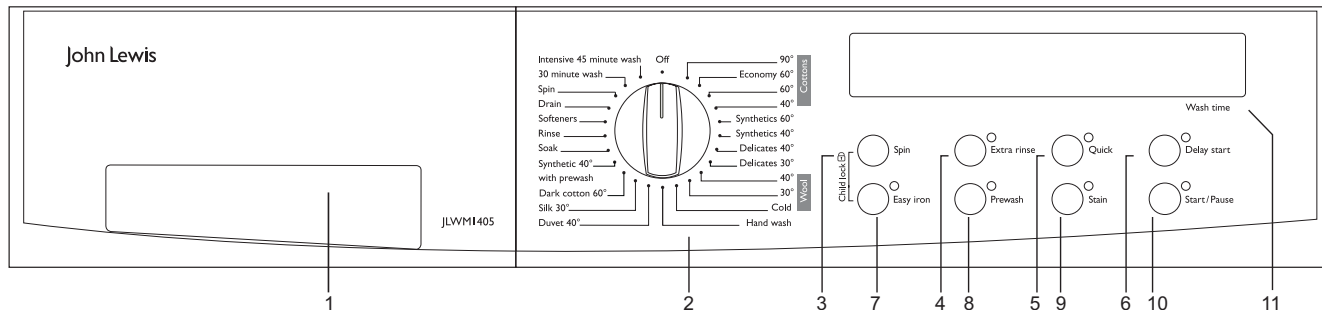

## 1 Detergent dispenser drawer

## 2 Programme selector dial

The selector is divided into the following sections:

- Cottons, linens
- Synthetics
- Delicates
- Wool / handwash
- Special programmes from “Duvet 40°” to “Intensive 45 minute wash”.
- Reset / Off programme **OFF**

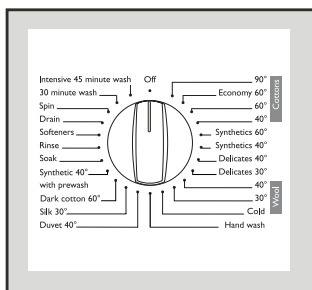

The selector dial can be turned either clockwise or anticlockwise.

Positions “**Economy 60°**” correspond to an ENERGY SAVING programmes and position “Cold” to a cold wash. Before setting the dial to any position ensure that the machine is turned to the “Off” position.

### Important

**At the end of the programme the selector dial must be turned to position “Off”.**

## 3 Spin button

Press this button to reduce the maximum speed of the final spin proposed by the machine for the selected programme.

The display will show the selected spin speed and only for 5 seconds the max speed allowed for the selected programme.

After 5 seconds the display will show selected spin speed and then the selected programme.

If you select «**U**» option, the machine eliminates all the spin phases. The display will show for 5 seconds the message «**No Spin**».

## Spin speed

The following speeds are available for the different fabrics:

- Cottons : 1200/ 1000/ 800/ 600/ 400/ 0 max 1400 r.p.m.
- Synthetics and Wool : 800/ 600/ 400/ 0 max 900 r.p.m.
- Delicates and Silk : 600/ 400/ 0 max 700 r.p.m.

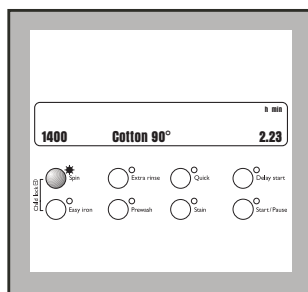

## No spin «**U**» option

No spin option can be selected by depressing the spin button. By selecting this option the spinning phases are suppressed.

If you select this option with programmes for cotton and synthetics, the machine will perform some extra rinses.

## 4 Extra rinse button

This option can be selected with all programmes, except the “Wool” programmes, “Duvet 40°”, “Handwash”, “Softeners” and “30 Minute wash”.

The machine will add 2 rinses for cotton and 1 rinse for Synthetics and Delicates.

This option is set as default for “Dark cotton 60°” and that cannot be turned off.

This option is recommended for people who are allergic to detergents, and areas where the water is very soft.

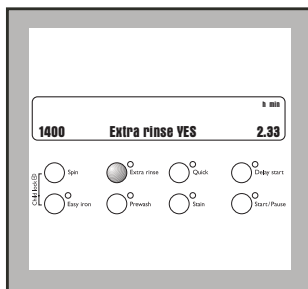

## 5 Quick button

This option can be used for lightly soiled items in order to obtain a good washing programme in a short time.

This option is not available for “Economy 60°”, “Wool”, “Handwash”, “Duvet 40°”, “Silk 30°”, “Softeners”, “30 minute wash” and “Intensive 45 minute wash” programmes.

The washing time will be reduced according to the type of fabric .

When this option is selected the corresponding light illuminates and the display shows “Quick” for 5 seconds .

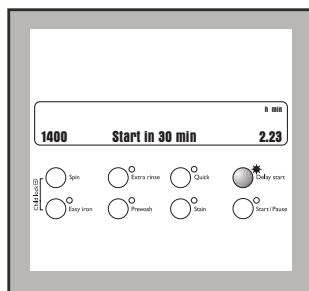
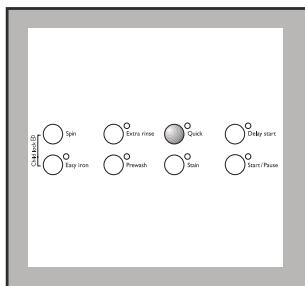

## 6 Delay Start button

The wash programme can be delayed from 30 min – 60 min – 90 min, 2 hours and then by 1 hour up to a maximum of 20 hours by means of this button.

### Selecting the delayed start

- Select the programme and the required options.
- Select the delay start.  
The corresponding light illuminates and the display shows for 5 seconds the message «**Start in...**» to indicate that a delay start has been selected.
- Depress “Start/ Pause” button: the machine starts its countdown in hours and, for the last 2 hours, in minutes.

The programme will start after the selected delay has expired.

### Cancelling the delayed start

- Depress “Start/ Pause” button.
- Depress repeatedly “Delay start” button until the message «**Delay Start NO**» is displayed.
- Depress “Start/ Pause” button again to start the programme.

### Important!

The door will be locked throughout the delay time (the door locked light is on).

If you need to open the door, you must first set the washing machine to Pause by pressing the “Start/ Pause” button. The door locked light goes out. After you have closed the door press the “Start/ Pause” button again.

## 7 Easy Iron button

Selecting this button the laundry is gently washed and spun to avoid any creasing. In this way ironing is easier. Furthermore the machine will perform 6 rinses instead of 3 for cotton and synthetics.

This function can be used for cotton and synthetic fabrics. If this option is selected for cotton programmes, the spin speed automatically will reduce to 1000 rpm.

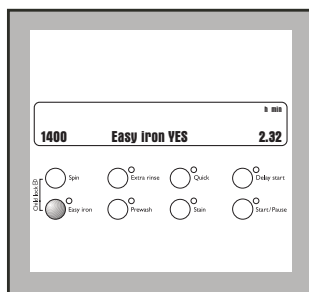

## 8 Prewash button

Select this option if you wish your laundry to be prewashed before the main wash (not available for Wool, “Handwash”, “Duvet 40°”, “Silk 30°”, “Softeners”, “30 Minute wash” and “Intensive 45 minute wash”).

This option is set as default for “Synthetic 40° with prewash” programme and that cannot be turned off.

The prewash ends with a short spin at 650 rpm in programmes for cotton and synthetic fabrics, whereas in the programme for delicate fabrics the water is only drained. This option can be selected for heavily soiled laundry but not together with “Stain” option.

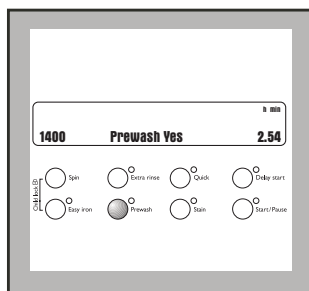

## 9 Stain button

Select this button if you wish to add to the washing of heavy soiled laundry a stain phase: at the temperature of 40°C the special detergent for stains is loaded from the compartment marked .

This function is available in cotton, synthetic & delicate programmes with a temperature of 40° or higher. The washing time will be prolonged by few minutes.

The “Prewash” and the “Stain” options cannot be selected together

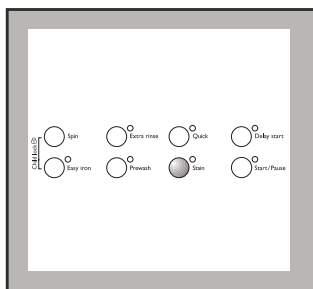

## 10 Start / Pause button

This button has two functions: **Start – Pause**.

### Start

After having selected the required programme, press this button to start the machine; the corresponding pilot light stops flashing and stays on during the washing programme.

If you have selected the delayed start, the machine begins its countdown. The duration of the programme and the delay appears on the display.

### Pause

To interrupt a programme which is running, depress the “Start/ Pause” button: the corresponding pilot light starts start to flash.

To restart the programme from the point at which it was interrupted, **press the “Start/ Pause” button again**.

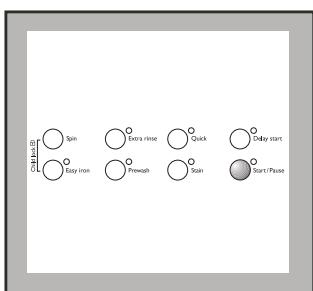

At the end of the programme the Start/pause button light goes out.

## 11 Display

The display shows the following information:

**Duration of the programme – spin speed - option selection - washing phases - delayed start – incorrect option selection – alarm message – end of programme.**

### Duration of the selected programme

After selecting a programme, the duration is displayed in hours and minutes (for example 2.23).

The duration is calculated automatically on the basis of the maximum recommended load for each type of fabric.

If the load of laundry to be washed is small, at the beginning of the cycle the display will still indicate the programme duration relevant to the maximum load. The duration value will be gradually adjusted during the execution of the cycle.

After the programme has started, the remaining time is updated every minute.

### Standby

After 10 minutes of inactivity in Setup Mode or at the End of the Cycle, the backlight of the display automatically switches off. Pressing any key or moving the selector the display returns in its normal status.

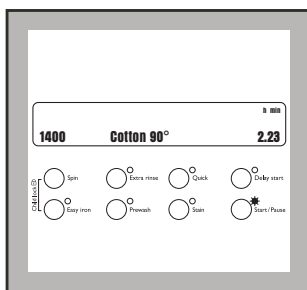

### Spin speed

After selecting a programme, the maximum spin speed proposed for the selected fabric/programme is displayed.

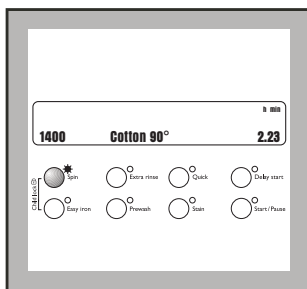

If you press repeatedly the “Spin” button it is possible to reduce the spin speed proposed by the machine.

If you select «0» all the spin phases will be suppressed. The display will show for 5 seconds the message «No spin».

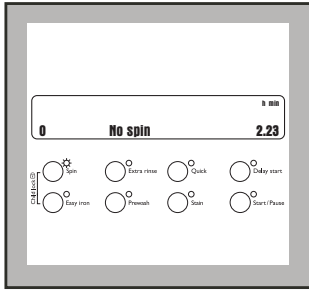

### Option selection

Depending on the programme, different functions can be combined. These must be selected after choosing the desired programme and before depressing the “Start/ Pause” button.

When you press an option button, (for ex. the Prewash ) the corresponding light illuminates and, on the display, appears the description of the selected function.

If you press the same button again, the button light goes out and the display shows that this option has been deactivated.

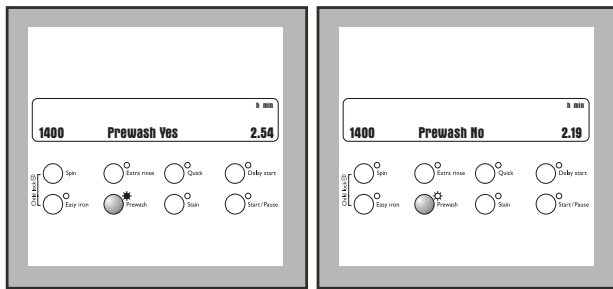

### Washing phases

During the washing cycle, the display will show the different washing phases.

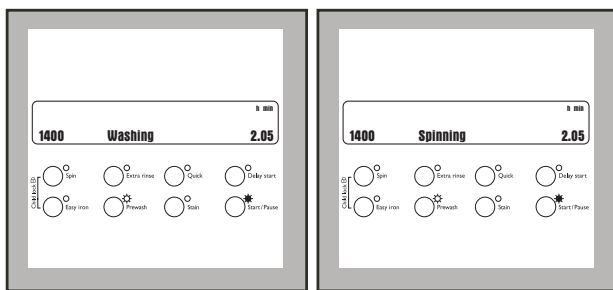

### Delayed start

The selected delay (20 hours max) set by means of the relevant button appears on the display for 5 seconds, then the selected programme displays. Press the Start/ Pause button to start the delay start.

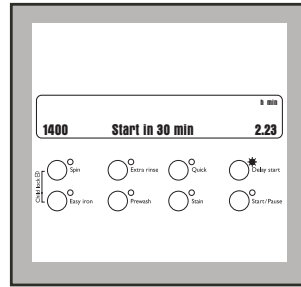

The countdown is updated every hour and for the last 2 hours, every 30 minutes.

### Incorrect option selection

If an option which is not compatible with the set wash programme is selected, the message «**Selection error**» is displayed for about 3 seconds.

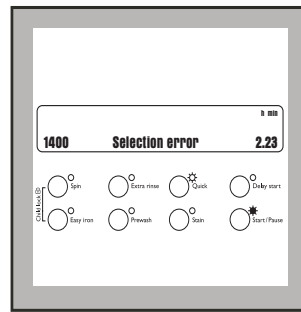

### Alarm messages

In the event of operating problems, some corresponding messages are displayed (for more information see paragraph “Something not working” at page 25).

Some of these problems are due to an incorrect use of your washing machine and are easy to resolve.

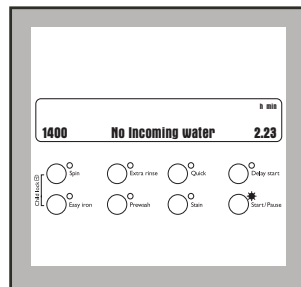

### End of programme

When the programme has finished (when the water has emptied out) and the light of the “Start/ Pause” button and the door locked light go out, then the door can be opened and the display will show alternatively the messages «**Door openable**» and «**Cycle ended**».

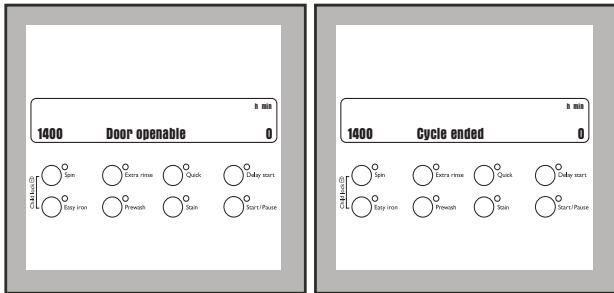

## Programme information

### Cottons 90°- 60°- 40°

These programmes must be used for lightly or normally soiled cotton. The washing time will be reduced only by a few minutes.

They can be used in combination with all Wash options.

### Wool 40°- 30°- Cold

These programmes for machine washable wool as well as for handwashable woollens and delicate fabrics.

### Duvet 40°

This programme can be used for Acrylic, polyester items and duvets. The machine performs 3 rinses, followed by a short spin.

### Dark cotton 60°

This is a special programme to wash jeans, synthetic fabrics and dark cottons.

### Rinses

With this programme it is possible to rinse and spin the cotton or linen garments which have been washed by hand. The machine performs 3 rinses, followed by a final spin at the maximum speed. The spin speed can be reduced by depressing the button.

The final spin is foreseen only for cotton items as in the spin programme.

### Softeners

Hand washed garments can be starched or softened with this programme.

The machine performs 1 rinse, followed by a final long spin at the minimum speed which can be reduced by depressing the "Spin" button.

The final spin is foreseen only for cotton items as in the spin programme.

### Drain

Turn first the programme selector dial to "Off", then select programme (Drain) and finally depress the "Start/ Pause" button.

### Spin

Separate spin at the maximum speed for hand washed garments. It must be used for cotton items. You can reduce the speed by means of button to adapt it to the fabrics to be spun.

### Synthetic 40° with pre-wash

This program can be used for especially dirty outdoor sport clothes. If this program is selected, the cycle is running automatically with prewash. The Prewash - LED is switched on.

### 30 Minute wash

This is a complete programme that can be combined with the following options:

"Spin" spin reduction and "Delay Start". To be used for laundry which is lightly soiled or which needs freshening up.

Max. load 3 Kg.

Programme duration 30 minutes.

Final spin speed 700 rpm.

### Intensive 45 minute wash

This is a complete programme to be used for half load of slightly or normally soiled cotton items. This programme performs the A-class washing efficiency in a short time.

It can be selected with the following options: spin speed reduction, no spin, extra rinse and delayed start.

Max load: 4 kg

Washing temperature: 60° C

Duration of the programme: 45 min.

Final spin speed: 1200 r.p.m.

### Off = Reset / Switching the machine off

To reset a programme turn the selector dial to "Off". Now a new programme can be selected.



# Special Features

## Child lock

The 'Child Lock' feature will allow you to lock the controls while the machine is running to prevent tampering.

To activate 'Child Lock' the machine must be running. e.g., Programme must be selected and the programme started by pressing the 'Start' button. Activate 'Child Lock' by pressing the 'Spin' and 'Easy Iron' buttons simultaneously for 5 seconds until the padlock symbol  is displayed on the screen.

To de-activate 'Child Lock' simply press the 'Spin' and 'Easy Iron' buttons simultaneously until the padlock symbol  in the screen disappears.

'Child Lock' will remain activated until you deactivate it, even if the machine is turned off.

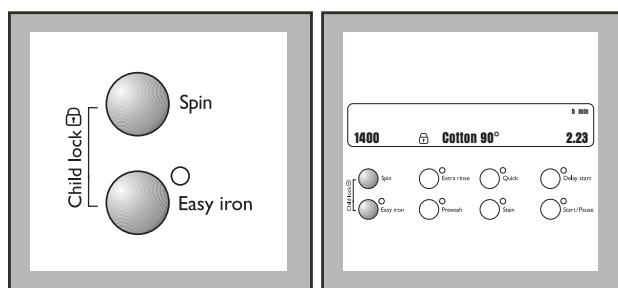

## Buzzer

This appliance incorporates a buzzer, which makes sound an acoustic signal when selecting the programmes, in case of an incorrect option selection, if the programme selector dial is turned to an other washing position during the programme, at the end of the cycle and in the event of operating problems.

To deactivate the acoustic signal, press simultaneously for 3 seconds the buttons "Extra rinse" and "Prewash" until the display will show for 5 seconds the message «**Buzzer NO**».

By pressing these 2 buttons again the acoustic signal is reactivated. The display will show for 5 seconds the message «**Buzzer YES**».

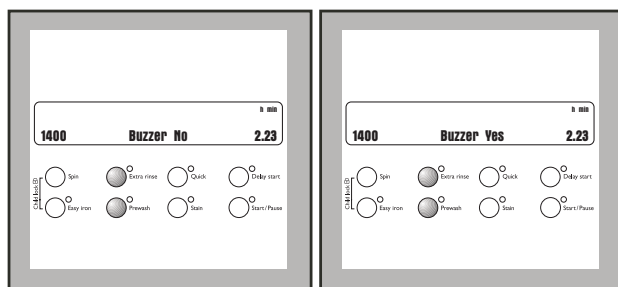



# Using your washing machine

Before the first wash, we recommend that you pour 2 litres of water into the main wash compartment  of the detergent drawer. Then run a cotton 90°C cycle, without any laundry in the machine, to remove any manufacturing residue from the drum and tub. Pour 1/2 a measure of detergent into the dispenser drawer and start the machine.

## WASHING 5 KG OF WHITE COTTON AT 90°C

Suppose you have 5 kg of laundry to wash. It is white cotton and is suitable for high temperature washing.

### 1. Load the laundry

Open the door. Place the laundry in the drum, one item at a time, shaking them out as much as possible. Close the door.

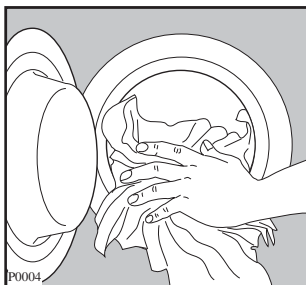

### 2. Measure out the detergent



Pull out the dispenser drawer until it stops. Measure out the amount of detergent required and pour it into the main wash compartment .

If you wish to carry out the prewash, a soak programme or a stain phase, pour detergent or stain remover into the appropriate compartment marked .

#### Important!

Do not use normal detergent for the “Stain” option, always use a STAIN remover.

### 3. Measure out the fabric softener

If required, pour fabric softener into the compartment marked , and bleach in to the compartment marked , without exceeding the «MAX» mark.

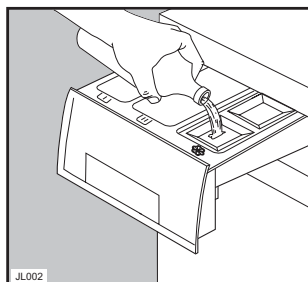
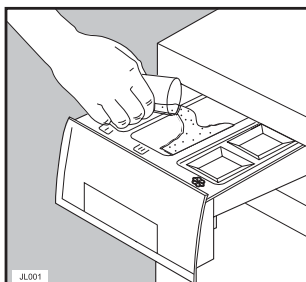

### 4. Select the desired programme

Turn the programme selector dial to the desired position. The duration of the programme and the maximum spin speed allowed for the selected programme appear on the display.

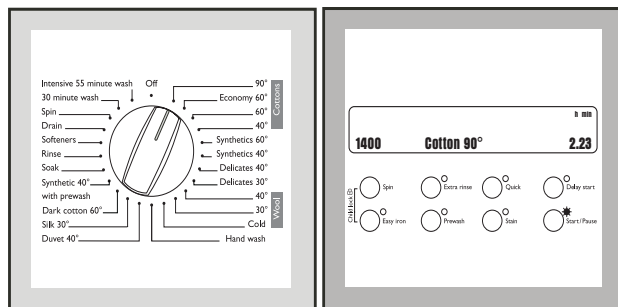

### 5. Select the spin speed or «0» (No spin) option

Depress repeatedly the spin speed button to choose the required speed or «0» (No Spin) option.

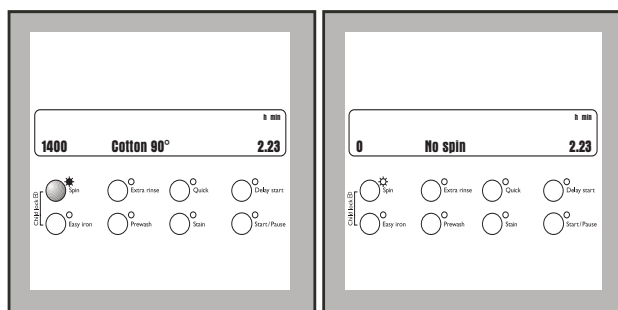

### 6. Select the desired options

Depress the button relevant to the selected option. The corresponding light illuminates and the display shows the description of the selected option.

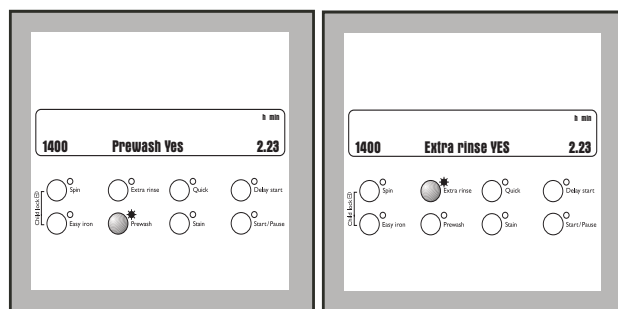

## 7. Select the Delay start

The delay starting of a programme, press repeatedly the “Delay Start” button to select the desired delay. The figures corresponding to the selected delay will be displayed for about 5 seconds.

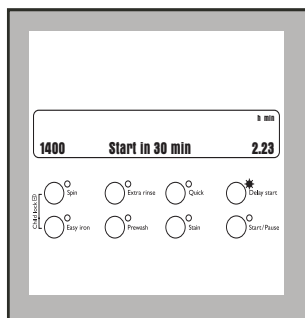

## 8. Start the programme

To start the selected programme, press the “Start/ Pause” button; the corresponding light stops flashing and stays on. The machine starts operating. The door locked light illuminates to indicate that the door is blocked.

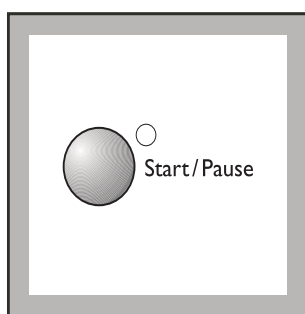

If you have selected the delay start the machine starts its countdown. The display shows the delay and the duration of the programme.

During this period it is possible to load other laundry:

- depress “Start/ Pause” button, the door locked light goes off.
- load the laundry.
- close the door and depress “Start/ Pause” button again.

## 9. How to change an option or a programme during its cycle

It is possible to change any option before the programme carries it out.

Before you make any change, you must pause the washing machine by pressing the “Start/ Pause” button. Changing a running programme is possible only by resetting it.

Turn the programme selector dial to “Off” and then to the new programme position. The washing water in the tub will not emptied out. Start the new programme by depressing the “Start/ Pause” button.

## 10. How to Interrupt a programme

Depress the “Start / Pause” button to interrupt a programme which is running, the corresponding light starts to flash. Depress the same button again to restart the programme.

## 11. How to open the door during the cycle of a programme

You can open the door, after having set the washing machine to Pause, provided the following conditions exist:

- the washing machine is not in the heating phase beyond 55°C;
- the level of the water is not high;

If these requirements are met, when you pause the washing machine, the door locked light goes off and the door can be opened.

Should it not be possible to open the door, and should it be absolutely necessary to do so, switch the machine off by turning the selector dial to “Off”.

After approximately 3 minutes, you can open the door.

### **Pay attention to the level and temperature of the water in the washing machine!**

When you close the door to restart the programme turn the dial to the previous programme repeating the options previously selected and press “Start/ Pause” button.

## 12. End of programme

The machine stops automatically. The light of the “Start / Pause” button goes out, the display shows alternatively the messages «Door openable» and «Cycle ended» and some acoustic signals are given.

Turn the programme selector dial to Reset “Off” to switch the machine off.

Remove the laundry from the washing machine.

Check whether the drum is completely empty, by rotating it with your hand. The purpose of this is to prevent any items of laundry from remaining accidentally in the drum, where they might get damaged in a subsequent wash (e.g. by shrinking) or bleed colour into another load of laundry.

We advise you to close the water supply tap and disconnect the plug from the socket.

Leave the door ajar in order to air the washing machine.

# Hints and Tips on Washing

Do NOT overload the machine. Weigh the laundry the first few times you use the appliance.

The average weights of the most common items are listed below as a guide:

1000g = 1 kg

Sheet	700-1000 g
Pillow case	100-200 g
Tablecloth	400-500 g
Serviette	50-100 g
Tea towel	70-120 g
Linen hand towel	100-150 g
Towelling hand towel	150-250 g
Towelling bath towel	700-1000 g
Bath robe	1000-1500 g
Man's shirt	200-300 g
Apron	150-200 g

- Load the laundry loosely alternating large items with small ones.
- Sort the laundry according to the type of fabric, colour-fastness and how dirty it is.
- Avoid washing unhemmed or torn items as they may unravel.
- Before washing, empty all pockets of small objects which may have been left inside (coins, keys, screws etc). as these could damage the drain pump.
- When washing curtains, remove the hooks.
- Close poppers and zips and fasten loose buttons.
- It is essential to wash new coloured items separately when washing for the first time.
- When washing fabrics requiring different wash temperatures together, always select the lowest temperature.
- White items should not be washed with coloured items.
- Very small items (handkerchiefs, ribbons, socks etc) should be washed in a washing bag or a pillow case.
- Use a good quality detergent suitable for automatic washing machines.
- Use the correct quantities of detergent.
- For wool, use gentle detergent only in small quantities.
- Bleach is very corrosive; it should be used with care and kept out of reach of children.
- Some stains such as fruit, wine, grass, rust etc. are difficult to remove and should be treated before washing with specific products, which can be found in most household shops. In some cases it may help to soak the stain before washing with a special pre-soak product or biological detergent.
- Only wool marked "Pure New Wool - washable, preshrunk" can be washed in the the wool programme; other types of wool should be washed in Wool programme.
- If you have used the machine to wash, rinse or spin only non-colour fast garments, there may be dye left in the sump. To ensure any subsequent wash is not contaminated with the dye, select and carry out a rinse and spin programme, without any garments, to ensure that any dye is removed from the sump.
- Once you have finished using the machine, you are advised to unplug it and turn off the water tap.

# Wash Care Symbols

Wash care labels inside garments recommend how to launder your clothes with the best results. The care labelling code is in line with care labelling used in the rest of Europe. The symbols used make it easy to select the correct programme on your washing machine.

WASHING SYMBOL	WASH ACTION	FABRIC
	Normal (Maximum)	White Cotton or Linen without Special Finishes
	Normal (Maximum)	Cotton, Linen or Viscose without Special Finishes Colourfast at 60°C.
	Reduced (Medium)	Nylon, Polyester/Cotton, Viscose with Special Finishes, Cotton/Acrylic Mix.
	Normal (Maximum)	Cotton, Linen or Viscose Colourfast at 40°C but not 60°C.
	Reduced (Medium)	Acrylics, Acetate, Triacetate, Wool mixes, Polyester/wool blends.
	Much Reduced (Minimum)	Wool, wool mixtures, Silks
	Hand wash only	Do not machine wash
<b>BLEACHING</b>		
	Chlorine bleach may be used	
<b>IRONING</b>		
	Hot iron	Cotton, Linen, Viscose
	Warm iron	Polyester mixtures, Wool
	Cool iron	Acrylic, Nylon, Polyester
<b>DRY CLEANING</b>		
	May be dry cleaned. Other letters and/or a bar beneath the circle will indicate the required process to the dry cleaner.	
<b>TUMBLE DRYING</b>		
	with high heat setting	
	with low heat setting	
	May be tumble dried	
	A cross through any symbol means « <b>DO NOT</b> »	

## Important Notes

For best results, always use the dispenser drawer for dispensing detergents and liquid additives. Once the dispenser has been filled, close it by pushing it in gently. This is particularly important if you are using

fabric conditioner to avoid the conditioner entering the machine prematurely.

When using liquid detergent and a prewash programme, place the detergent into the correct compartment in the dispenser drawer, after the prewash has finished.

# Washing programmes

Fabrics	Programme	Type of laundry	Available options	Load	Consumptions*	
					Energy kWh	Water litres
White cotton	<b>Cottons 90°</b>	Sheets, household linen, towels, tablecloths	Spin red./ No Spin Extra rinse Quick, Delay Start Prewash, Easy Iron, Stain	8 Kg	2.90	75
White cotton	<b>Cottons Economy 60°</b>	Sheets, household linen, towels, tablecloths	Spin red./ No Spin Extra rinse, Delay Start, Prewash, Easy Iron, Stain	8 Kg	1.36	60
White and coloured cotton	<b>Cottons 60°</b>	Fast coloured and non-fast items, for example hand towels, sheets, underwear, tablecloths, shirts, blouses	Spin red./ No Spin Extra rinse Quick, Delay Start Prewash, Easy Iron, Stain	8 Kg	1.75	70
Coloured cotton	<b>Cottons 40°</b>	Coloured items, for example underwear, shirts, blouses	Spin red./ No Spin Extra rinse, Quick, Delay Start, Prewash, Easy Iron, Stain**	8 Kg	1.05	70
Synthetics	<b>Synthetics 60°</b>	Shirts, blouses, underwear, mixed fabrics	Spin red./ No Spin Extra rinse Quick, Delay Start Prewash, Easy Iron, Stain	3.5 Kg	1.00	59
Synthetics	<b>Synthetics 40°</b>	Shirts, blouses, underwear, mixed fabrics	Spin red./ No Spin Extra rinse Quick, Delay Start Prewash, Easy Iron, Stain	3.5 Kg	0.58	55
Delicates	<b>Delicates 40°</b>	Acrylic, viscose, polyester items, curtains	Spin red./ No Spin Extra rinse Quick, Delay Start Prewash, Stain	3.5 Kg	0.60	65
Delicates	<b>Delicates 30°</b>	Acrylic, viscose, polyester items, curtains	Spin red./ No Spin Extra rinse Quick, Delay Start Prewash	3.5 Kg	0.35	65
Wool	<b>40° - 30° - Cold Wool</b>	Garments bearing the “ Pure new wool, non-shrink, machine washable” or “Hand wash” label	Spin red./ No Spin Delay Start	2 kg	0.45	65
Special programme for hand washing fabrics.	<b>Hand wash</b>	Delicate fabrics, silk to be handwashed	Spin red./ No Spin Delay Start	2 kg	0.35	65

The “Cottons Economy 60° ” is the reference programme for the data entered in the energy label, in compliance with EEC 92/75 standards.

\*This data is given purely as an indication : the consumption values may vary in relation to the quantity and type of laundry, the temperature of the water supply and the ambient temperature. The data refers to the highest temperature provided for each programme.

Programme	Programme description	Type of laundry	Available options	Load	Consumptions*	
					Energy kWh	Water litres
<b>Duvet 40°</b>	Main wash at 40°C 3 rinses short spin	Acrylic, polyester items, duvets	Spin red./ No Spin Delay Start	2.5 Kg	0.70	80
<b>Silk 30°</b>	Main wash at 30°C 3 rinses short spin	Clothes labelled "Pure new wool, non-shrink machine washable" and silk fabric.	Spin red./ No Spin Delay Start, Extra rinse	1 Kg	0.30	75
<b>Dark cotton 60°</b>	Main wash at 40°C 3 rinses short spin	Washing for resistant fabric, for example trousers, T shirts and jeans.	Spin red./ No Spin Extra rinse Quick, Delay Start Prewash, Easy Iron, Stain	4 Kg	1.50	75
<b>Synthetic 40° with prewash</b>	Synthetic program with pre-wash i.e for especially dirty sports clothes	This program can be used for especially dirty outdoor sports clothes	Spin red./ No Spin Extra rinse Quick, Delay Start Easy Iron	3.5 Kg	0.80	70
<b>Soak</b>	Soak for 30 minutes at 30°C	Separate soak programme for lightly soiled items.	-	8 Kg	0.25	23
<b>Rinse</b>	3 rinses Long spin at the max speed	Separate rinse cycle for hand washed items of cotton fabric	Spin red./ No Spin	8 Kg	0.15	50
<b>Softeners</b>	1 rinse with liquid additive Long spin at max. speed	Hand washed garments can be starched or softened with this programme.	Spin red./ No Spin Easy Iron	8 Kg	0.05	23
<b>Drain</b> For emptying out after the programme "Soak 30° " or at the end of a programme with "Rinse hold" option	Water draining		-	8 Kg	-	-
<b>Spin</b>	Drain and long spin at max. speed*		Spin red.	8 Kg	-	-
<b>30 Minute wash</b> Short cycle for lightly soiled fabrics	Wash at 30°C 2 rinses Short spin	Special short programme for lightly soiled fabrics	Spin red./ No Spin	3 Kg	0.35	52
<b>Intensive 45 minute wash</b>	Main wash at 60°C 2 rinses. Short spin at 1200 r.p.m.	Special programme for half load of slightly or normally soiled cotton items	Spin red./ No Spin Delay Start, Extra rinse	4 Kg	0.90	50
<b>Off (Reset)</b>	For cancelling the programme which is running		-	-	-	-

\*You can reduce the spin speed by means of the relevant button to adapt it to the fabrics to be spun.

The machine may in some cases add or subtract rinses depending on the quantity and type of laundry.

# Maintenance and Cleaning

Before any maintenance or cleaning is carried out you must **DISCONNECT** the appliance from the electricity supply.

## Descaling

The water we use normally contains lime. It is a good idea to periodically use a water softening powder in the machine. Do this separately from any laundry washing, and according to the softening powder manufacturer's instructions. This will help to prevent the formation of lime deposits.

## After each wash

Leave the door open for a while. This helps to prevent mould and stagnant smells forming inside the appliance. Keeping the door open after a wash will also help to preserve the door seal.

## Maintenance wash

With the use of low temperature washes it is possible to get a build up of residues inside the drum. We recommend that a maintenance wash be performed on a regular basis.

To run a maintenance wash:

- The drum should be empty of laundry.
- Select the hottest cotton wash programme.
- Use a normal measure of detergent, must be a powder (such as Ariel Futur).

## External cleaning

Clean the exterior cabinet of the appliance with soap and water only, and then dry thoroughly.

## Cleaning the dispenser drawer

The washing powder and additive dispenser drawer should be cleaned regularly.

Remove the drawer by pressing the catch downwards and by pulling it out. Flush it out under a tap, to remove any traces of accumulated powder. To aid cleaning, the top part of the additive compartment should be removed.

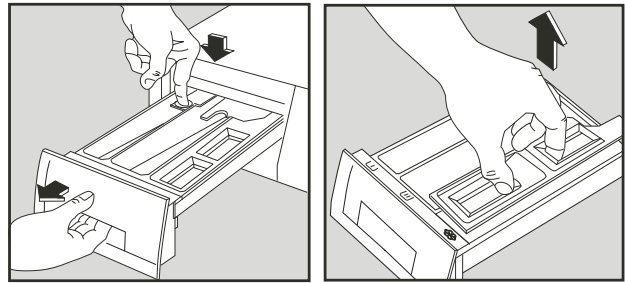

## Cleaning the drawer recess

Having removed the drawer, use a small brush to clean the recess, ensuring that all washing powder residue is removed from the upper and lower part of the recess. Replace the drawer and run the rinse programme without any clothes in the drum.

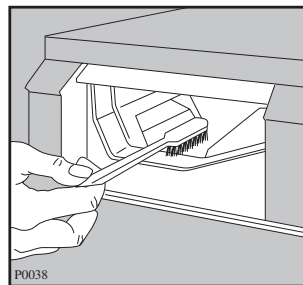

## Cleaning the pump

The pump should be inspected if

- the machine does not empty and/or spin
- the machine makes an unusual noise during draining due to objects such as safety pins, coins etc. blocking the pump.

Proceed as follows:

- Disconnect the appliance.
- If necessary wait until the water has cooled down.
- Open the pump door.

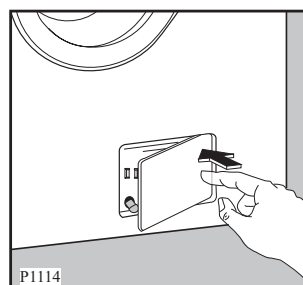

- Place a container close to the pump to collect any spillage.
- Pull out the emergency emptying hose, place it in the container and remove its cap.

- When no more water comes out, unscrew the pump cover and remove it. Always keep a rag nearby to dry up spillage of water when removing the cover.

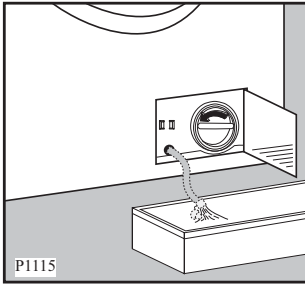

- Remove any objects from the pump impeller by rotating it.

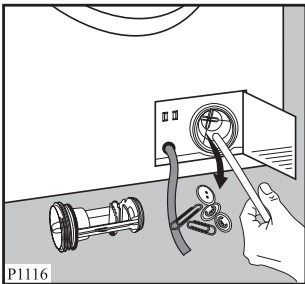

- Put the cap back on the emergency emptying hose and place the latter back in its seat.

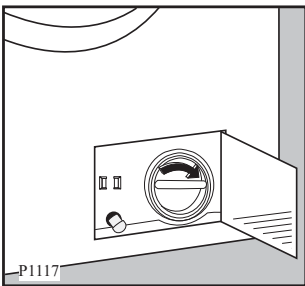

- Screw the pump cover fully in.
- Close the pump door.

### **Warning**

When the appliance is in use and depending on the programme selected there can be hot water in the pump. Never remove the pump cover during a wash cycle, always wait until the appliance has finished the cycle, and is empty. When replacing the cover, ensure it is securely retightened so as to stop leaks and young children being able to remove it.

## Cleaning the water inlet filter

If your water is very hard or contains traces of lime deposit, the water inlet filter may become clogged. It is therefore a good idea to clean it from time to time. Turn off the water tap. Unscrew the water inlet hose. Clean the filter using a hard bristle brush.

Tighten up the inlet hose.

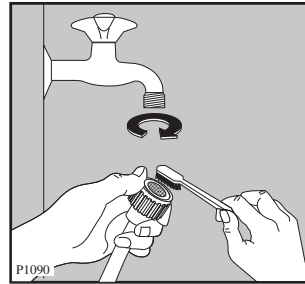

## The dangers of freezing

If the machine is exposed to temperatures below 0°C, certain precautions should be taken.

- Turn off the water tap.
- Unscrew the inlet hose.
- Place the end of the emergency emptying hose and that of the inlet hose in a bowl placed on the floor and let water drain out.
- Screw the water inlet hose back on and reposition the emergency emptying hose after having put the cap on again.
- When you intend to start the machine up again, make sure that the room temperature is above 0°C.

### **Important!**

**Every time you drain the water through the emergency emptying hose you must pour 2 litres of water into the main wash compartment of the detergent drawer and then run the drain programme.**

## Emergency emptying out

If the water is not discharged, proceed as follows to empty out the machine:

- pull out the plug from the power socket;
- close the water tap;
- if necessary, wait until the water has cooled down;
- open the pump door;
- place a bowl on the floor and place the end of the emergency emptying hose into the bowl. Remove its cap. The water should drain by gravity into the bowl. When the bowl is full, put the cap back on the hose. Empty the bowl. Repeat the procedure until water stops flowing out;
- clean the pump if necessary as previously described;
- replace the emergency emptying hose in its seat after having plugged it;
- screw the pump cover again and close the door.



# Something Not Working?

If the machine is not working correctly, please carry out the following checks before contacting your local Service Force agent.

**IMPORTANT:** If the END light flashes, the buzzer sounds and an alarm code is displayed, switch the machine off and call the telephone number given below.

**IMPORTANT:** If you call out an engineer to a fault listed below, or to repair a fault caused by incorrect use or installation a charge will be made even if the appliance is under guarantee.

During machine operation it is possible that the one of the following alarm codes appears on the display:

«No incoming water»: problem with the water supply

«No drain»: problem with water draining

«Close the door»: door open

Once the problem has been eliminated, press the START/PAUSE button to restart the programme. If after all checks, the problem persists, contact your local Service Centre.

Symptom	Solution
<ul style="list-style-type: none"> <li><b>The machine does not start up:</b></li> </ul>	<ul style="list-style-type: none"> <li>The door is not firmly closed. «Close the door»</li> <li>The machine is not plugged in or there is no power at the socket.</li> <li>The main fuse or the fuse in the plug has blown.</li> <li>The programme selector dial is not positioned correctly .</li> <li>The “<b>Delay Start</b>” option has been selected.</li> </ul>
<ul style="list-style-type: none"> <li><b>The machine does not fill:</b></li> </ul>	<ul style="list-style-type: none"> <li>The water tap is closed. «No incoming water»</li> <li>The inlet hose is squashed or kinked. «No incoming water»</li> <li>The filter in the inlet hose is blocked. «No incoming water»</li> <li>The door is not properly closed. «Close the door»</li> </ul>
<ul style="list-style-type: none"> <li><b>The machine fills then empties immediately:</b></li> </ul>	<ul style="list-style-type: none"> <li>The end of the drain hose is too low.</li> <li>The end of the drain hose is submerged in water.</li> <li>There is no vent in the end of the drain hose.</li> </ul>
<ul style="list-style-type: none"> <li><b>The machine does not empty and/or does not spin:</b></li> </ul>	<ul style="list-style-type: none"> <li>The drain hose is squashed or kinked. «No drain»</li> <li>The option “<b>No Spin</b>” has been selected.</li> <li>The drain pump is clogged. «No drain»</li> </ul>
<ul style="list-style-type: none"> <li><b>There is water on the floor:</b></li> </ul>	<ul style="list-style-type: none"> <li>Too much detergent or unsuitable detergent (creates too much foam) has been used.</li> <li>Check whether there are any leaks from one of the inlet hose fittings. It is not always easy to see this as the water runs down the hose; check to see if it is damp.</li> <li>The drain hose is damaged or not securely positioned</li> <li>The cap on the emergency emptying hose has not been replaced after cleaning the filter.</li> </ul>
<ul style="list-style-type: none"> <li><b>Unsatisfactory washing results:</b></li> </ul>	<ul style="list-style-type: none"> <li>Too little detergent or unsuitable detergent has been used. An insufficient amount of detergent leaves the laundry looking grey and causes lime scale to form.</li> <li>Stubborn stains have not been treated prior to washing.</li> <li>The correct programme/temperature was not selected.</li> </ul>

<b>Symptom</b>	<b>Solution</b>
<ul style="list-style-type: none"> <li>• <b>The machine vibrates when spinning</b></li> </ul>	<ul style="list-style-type: none"> <li>• The internal packing has not been removed.</li> <li>• The machine is in contact with the wall or furniture.</li> <li>• The machine is not level and stable (check diagonally).</li> <li>• The washing load is badly distributed in the drum.</li> <li>• Maybe there is very little laundry in the drum.</li> </ul>
<ul style="list-style-type: none"> <li>• <b>The door will not open:</b></li> </ul>	<ul style="list-style-type: none"> <li>• The water level is above the bottom edge of the door.</li> <li>• The machine is heating the water.</li> <li>• The drum is turning.</li> </ul> <p>The door could be opened only when “Door openable “ message appears in the display and the door locked light goes off.</p>
<ul style="list-style-type: none"> <li>• <b>Spinning starts late or the the machine does not spin</b></li> </ul>	<ul style="list-style-type: none"> <li>• The electronic balance control device has cut in because the laundry is not evenly distributed in the drum. The laundry is redistributed by reverse rotation of the drum. This may happen several times before the unbalance disappears and normal spinning can resume. If, after few minutes, the laundry is still not evenly distributed in the drum, the machine will not spin. In this case, redistribute the load manually and select the spin programme.</li> </ul>
<ul style="list-style-type: none"> <li>• <b>The machine makes an unusual noise</b></li> </ul>	<ul style="list-style-type: none"> <li>• The machine is fitted with a type of motor which makes an unusual noise compared with other traditional motors. This new motor ensures a softer start and more even distribution of the laundry in the drum when spinning, as well as increased stability of the machine.</li> </ul>
<ul style="list-style-type: none"> <li>• <b>No water is visible in the drum</b></li> </ul>	<ul style="list-style-type: none"> <li>• Machines based on modern technology operate very economically using very little water without affecting performance.</li> </ul>

## Repairs - After Sales Service

In the unlikely event of your appliance requiring service, or if you wish to purchase spare parts, please contact our extended warranty administrators by telephoning

**0870 01 07887**

They will give you details for your local Service Force Centre.

Before calling out an engineer, please ensure you have read the details under the heading "Something Not Working".

When you contact your local Service Force Centre you will need to give the following details:

1. Your name, address and post code
2. Your telephone number
3. Clear and concise details of fault
4. The purchase date and found on your receipt.
5. The model and serial number of the appliance (found on the rating plate - see picture on page 5)

So that you always have these numbers at hand, we recommend you to make a note of them here:

Mod. : .....

PNC : .....

S.N. : .....

Your dryer is covered by a 3 year parts and labour guarantee (see separate details given at point of sale). Please retain your purchase receipt safely for the service engineer to verify the purchase details.

## Spare parts

Always insist on genuine spare parts. An authorised service engineer should service this product, and only genuine spare parts should be used. Under no circumstances should you attempt to repair the machine yourself. Repairs carried out by inexperienced persons may cause injury or serious malfunctioning. Contact your local Service Force Centre. An authorised service engineer always insist on genuine spare parts.

John Lewis Partnership  
171 Victoria Street  
London SW1E 5NN

[www.johnlewis.com](http://www.johnlewis.com)