

Magiclean *Deep Fryer*

800

1000



www.groupeseb.com

Magiclean
Deep Fryer

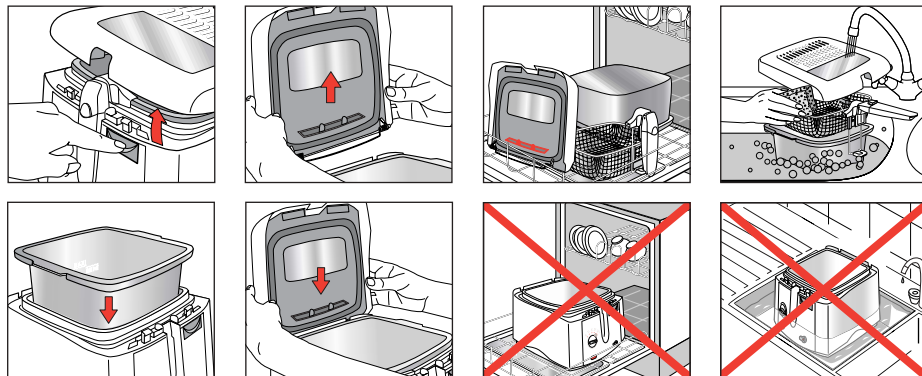
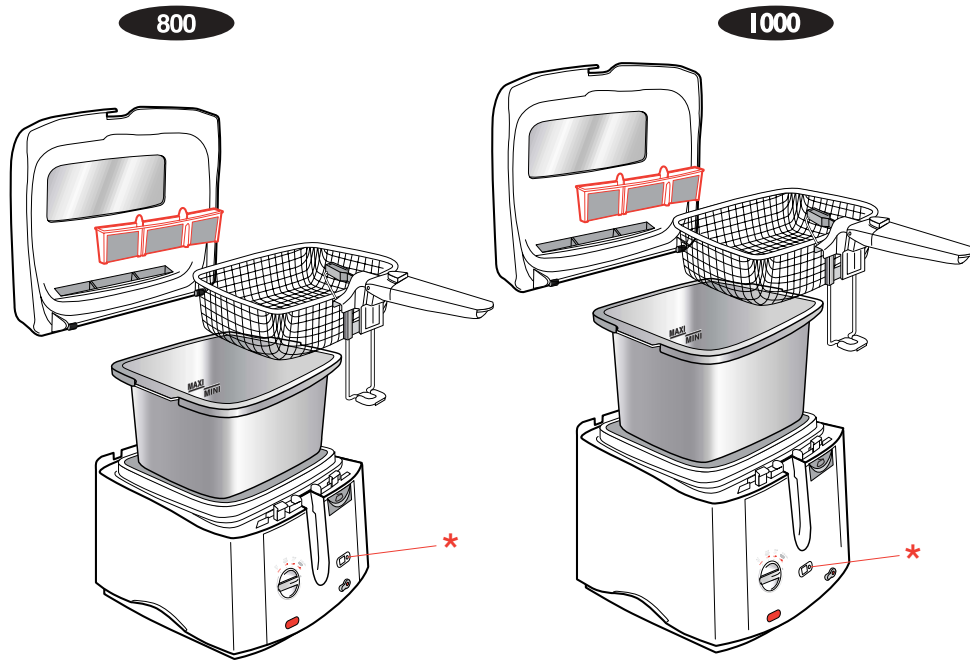

* selon modèle, depending on model, je nach Modell, niet op alle modellen aanwezig, a seconda del modello, según modelo, conforme o modelo, bazı modellerde, afhængig af model, beroende på modell, kun på noen modeller, mallista riippuen, ανάλογα με το μοντέλο, в зависимости от модели, w zależności od modelu, podle modelu, podľa modelu, modelltöl fúggðen, според модела, حسب الموديل

2



	800	1000
Min	1.4 l	1.8 l
Max	1.6 l	2.0 l

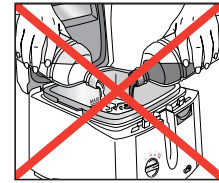
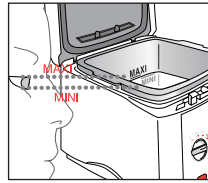
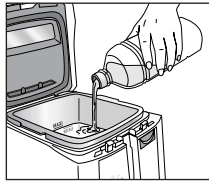

	800	1000
Min	1260g	1575g
Max	1440g	1750g

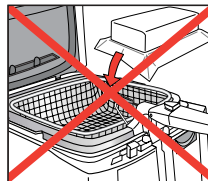
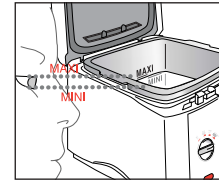
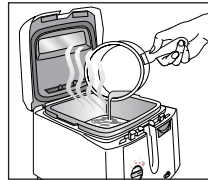
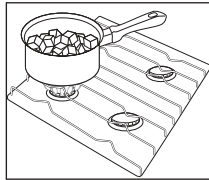

3

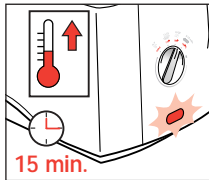
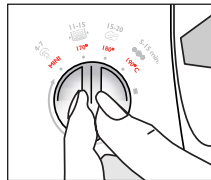
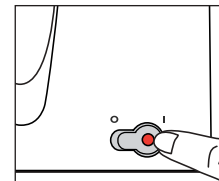
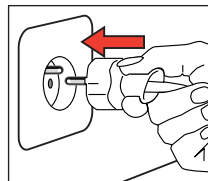
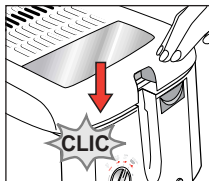

4

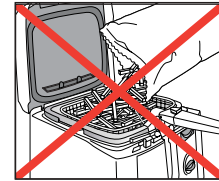
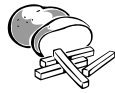

800	+/- 440/800 g	+/- 320/600 g
1000	+/- 550/1000 g	+/- 600/750 g

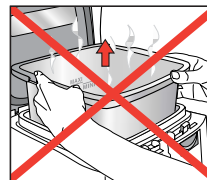
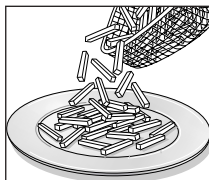
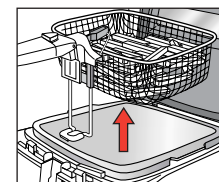
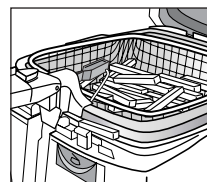
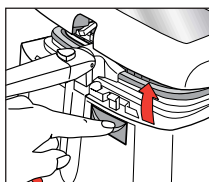
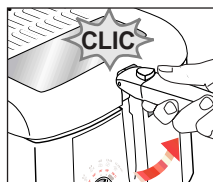
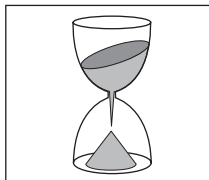
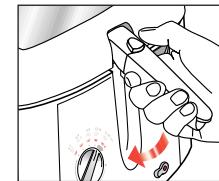
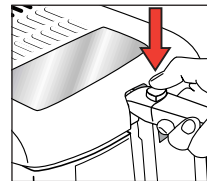
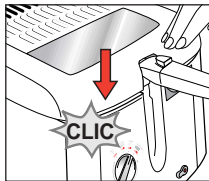
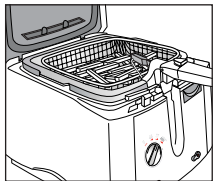
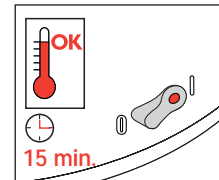
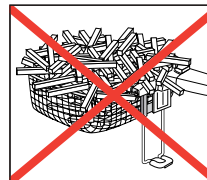
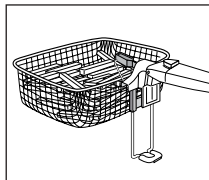
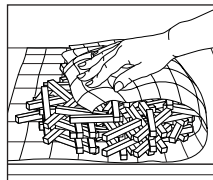

5

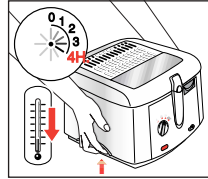
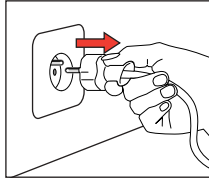
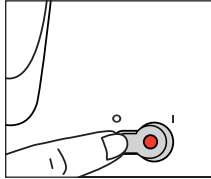

1000

6

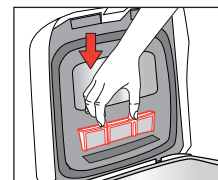
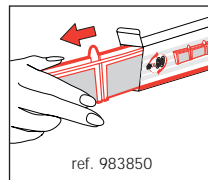
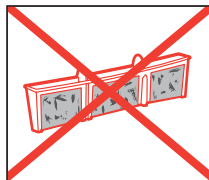
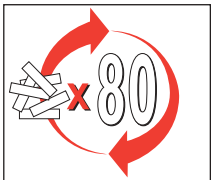
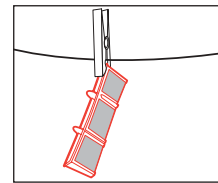
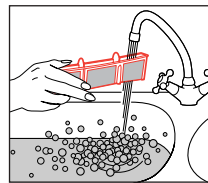
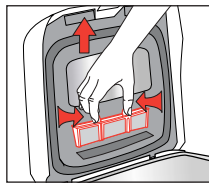
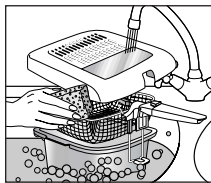
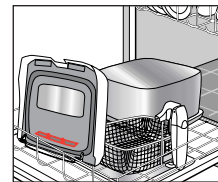
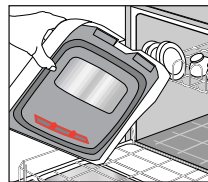
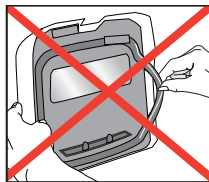
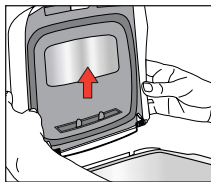









ref. 983850

7



Nb











				800	
		1000g	190°C		+/- 13-15 min.
		550g	190°C		+/- 9-11 min.
		800g	190°C	+/- 15-19 min.	
		440g	190°C	+/- 12-14 min.	
	8-11		190°C	+/- 9-10 min.	+/- 9-10 min.
	1		180°C	+/- 15-20 min.	+/- 15-20 min.
	1-2		170°C	+/- 6-8 min.	+/- 6-8 min.
	8		MINI	+/- 6-8 min.	+/- 6-8 min.
	6-8		170°C	+/- 3-4 min.	+/- 3-4 min.
	4		170°C	+/- 6-8 min.	+/- 6-8 min.
	6		190°C	+/- 2-3 min.	+/- 2-3 min.



Nb



				800	1000
		750g	190°C		+/- 11-13 min.
		400g	190°C		+/- 6-7 min.
		600g	190°C	+/- 12-15 min.	
		320g	190°C	+/- 7-10 min.	
		500g	190°C	+/- 8-10 min.	+/- 8-10 min.
	8		190°C	+/- 4-5 min.	+/- 4-5 min.
	12		190°C	+/- 4-5 min.	+/- 4-5 min.
	1-2		190°C	+/- 14-16 min.	+/- 14-16 min.
	16		190°C	+/- 4-5 min.	+/- 4-5 min.
	12		190°C	+/- 4-5 min.	+/- 4-5 min.
	6-8		190°C	+/- 3-4 min.	+/- 3-4 min.